

200W 425mm STROKE ELECTRIC ACTUATOR - PRELIMINARY MODIFICATION FOR MY1018Z MOTOR

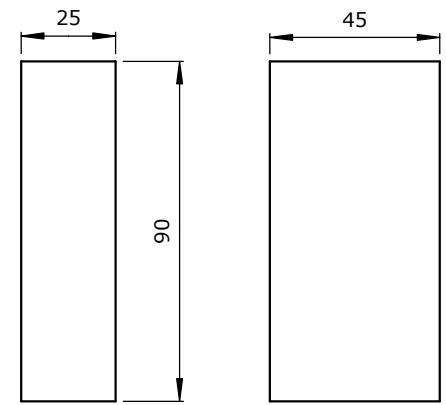
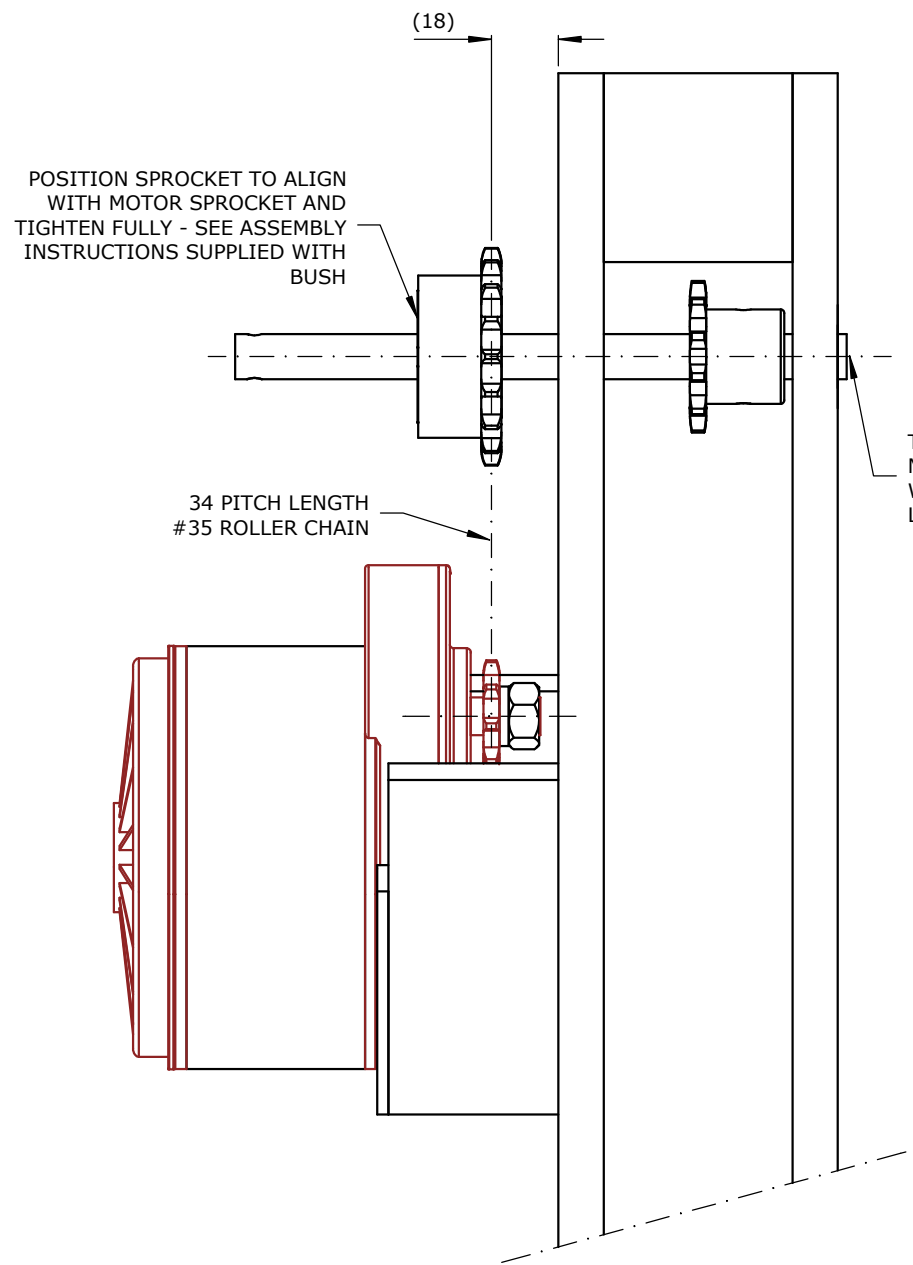

ITEM 1 - MOUNTING BLOCK
PLANED TIMBER
2 - OFF

THE ADDITIONAL SPROCKET MUST BE CAPABLE OF BEING FITTED AFTER THE SPINDLE IS ASSEMBLED IN THE ACTUATOR. 18 TOOTH IS SMALLEST AVAILABLE TAPERLOCK SPROCKET

#35 18 TOOTH TAPERLOCK BUSHED SPROCKET
EG - MARTIN 35BTB-18
1008 TAPERLOCK BUSH FOR 12MM SHAFT

MY1018Z 24V 250W MOTOR (FITTED WITH 9T #35 DRIVE SPROCKET)

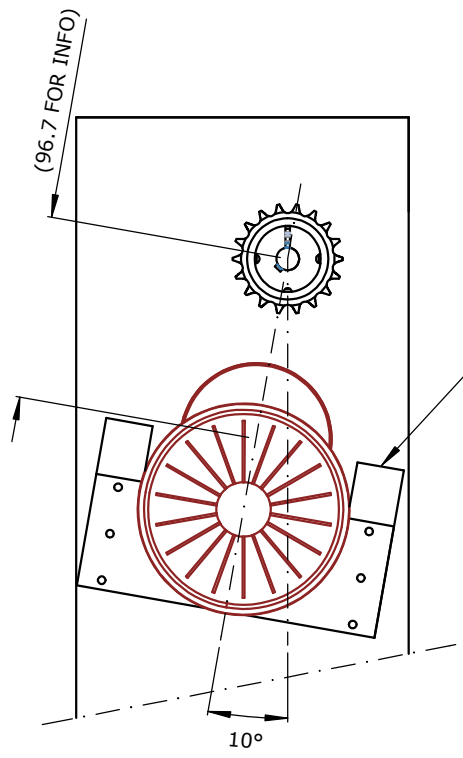
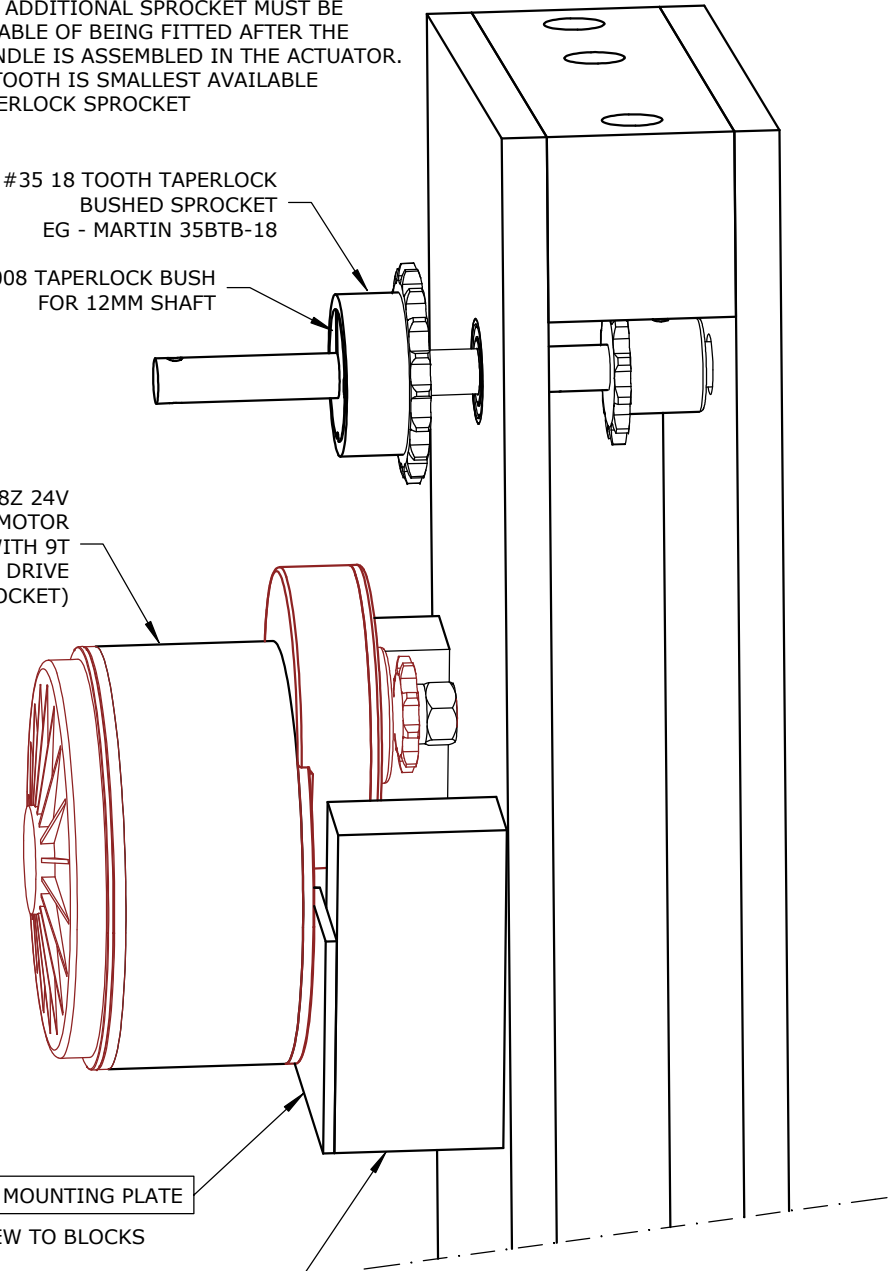

POSITION MOTOR AND SUPPORT ON ASSEMBLY TO SET ACCURATE CENTER DISTANCE

IMPORTANT -

A CHAIN COVER MUST BE FITTED OVER THE EXPOSED SPROCKET AND CHAIN TO PREVENT ACCIDENTAL CONTACT AND POSSIBLE INJURY.

THE PROPOSED DESIGN IS PRELIMINARY AND PROVIDED AS GUIDANCE ONLY FOR BUILDERS INTERESTED IN USING THE MY1018Z MOTOR - THIS MODIFICATION HAS NOT BEEN TESTED, USE WITH CAUTION.

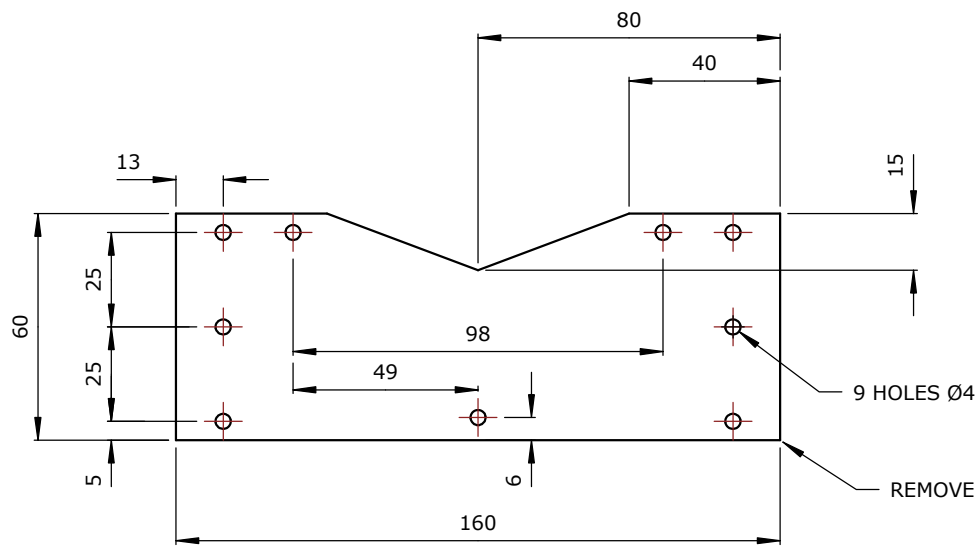

ITEM 2 - MOUNTING PLATE
3 MM STEEL FLAT
1 - OFF

© 2008 BFF Design Ltd. Conditions of use apply. See - buggies.builtforfun.co.uk

**ELECTRIC ACTUATOR
MY1018Z MODS**

SIZE	DRAWN BY & DATE	DWG NO	REV
A3	IH 6/08	ACT1-S004	1
SCALE	1:2 U.O.S.	UNITS	MM
			SHEET
			SHT 1 OF 1

